

WALL TYPES

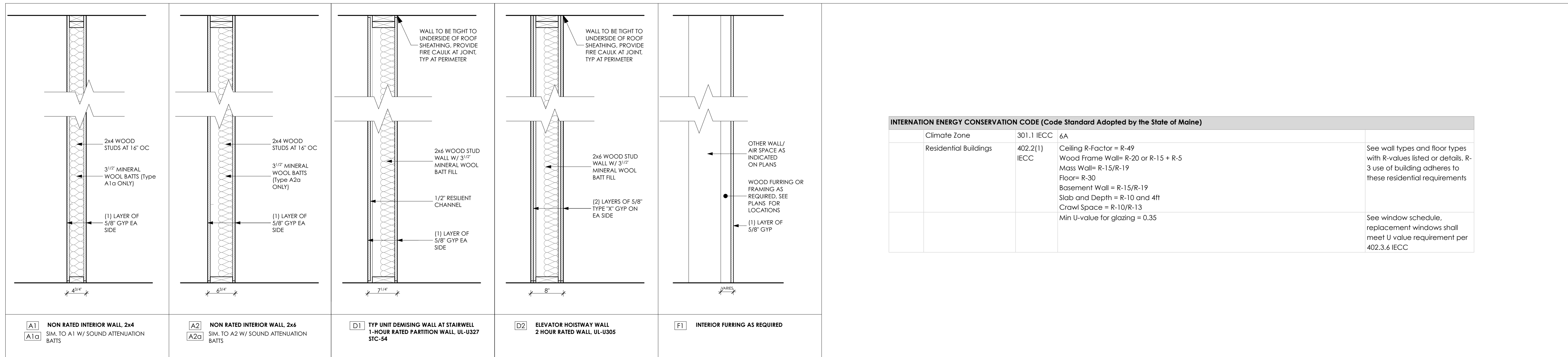
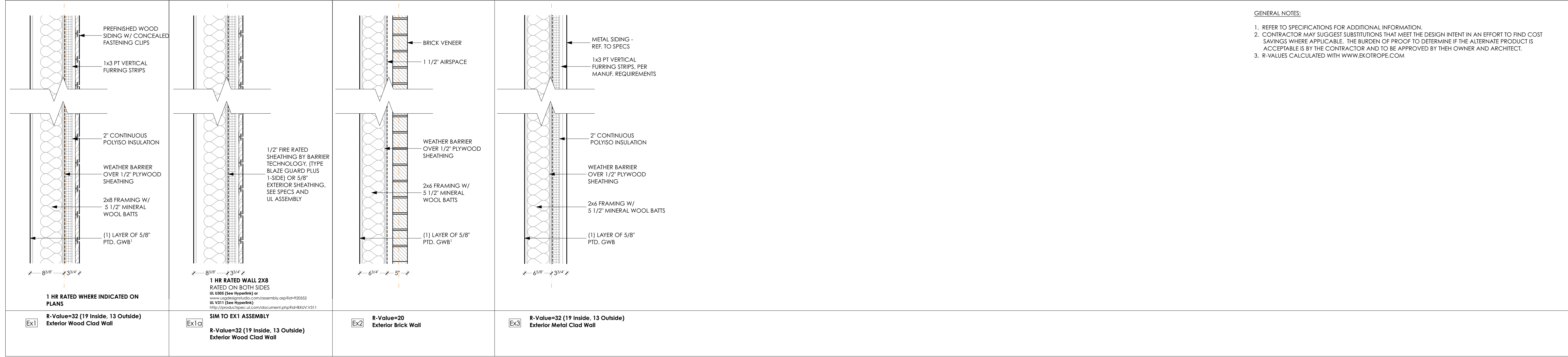

INTERNATIONAL ENERGY CONSERVATION CODE (Code Standard Adopted by the State of Maine)

Climate Zone	301.1 IECC	6A
Residential Buildings	402.2(1) IECC	Ceiling R-Factor = R-49 Wood Frame Wall = R-20 or R-15 + R-5 Mass Wall = R-15/R-19 Floor = R-30 Basement Wall = R-15/R-19 Slab and Depth = R-10 and 4ft Crawl Space = R-10/R-13 Min U-value for glazing = 0.35

See wall types and floor types with R-values listed or details. R-3 use of building adheres to these residential requirements.

See window schedule, replacement windows shall meet U value requirement per 402.3.6 IECC

General Notes:
1. Refer to Project Specifications for Material Selections and Requirements

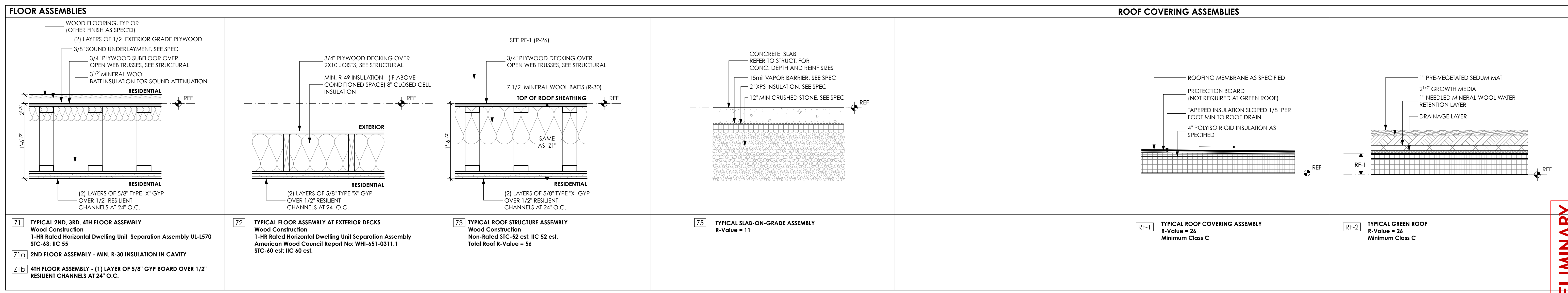

PARTITION TYPES
SCALE: 1" = 1'-0"

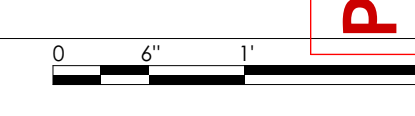

CHANGES THIS ISSUE

ID	DESCRIPTION

SUBMISSIONS:

ISSUE	DATE	DESCRIPTION
001	12/01/2017	CITY REVIEW
002	12/01/2017	DESIGN DEVELOPMENT LET

ARCHITECT: PBJ/JJK
DRAFTSPERSON: PBJ/JJK
DATE: 1/19/18
PROJECT STATUS: 25% Construction Docs

Brady Residence
Jim and Julia Brady
9 Moody Street Portland ME 04101

PRELIMINARY
NOT FOR CONSTRUCTION

BIM Server: bimservr.cjpb.me - BIM Server: 21/9 Moody Street/9 Moody Street_10052017