

85 MORNING ST.

TRIPLE 2" X 8" X 16"

APPROVED  
POST TO BEAM  
POST CAP  
ATTACHMENT

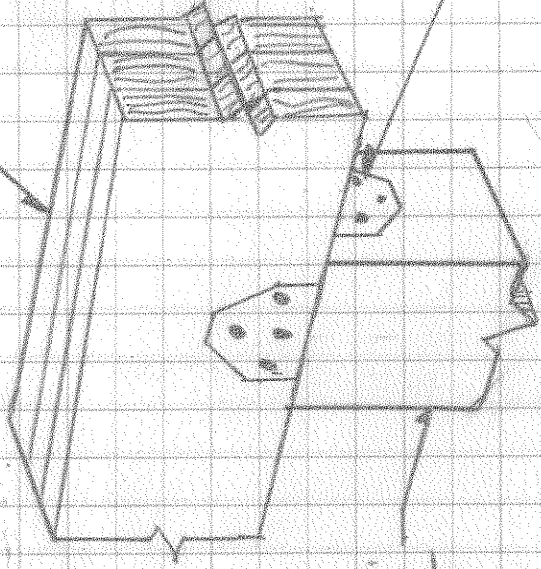

APPROVED  
POST TO BEAM  
POST CAP  
ATTACHMENT

6" X 6" POST

HOT-DIPPED GALVANIZED  
5/8" GALVANIZED THREAD  
ANCHOR WITH  
WASHER + NUT

6" X 6" Post

APPROVED  
CONCRETE TO  
DECK FASTENER

GRADE

48" X 8"  
CONCRETE PILLAR  
BELOW GRADE

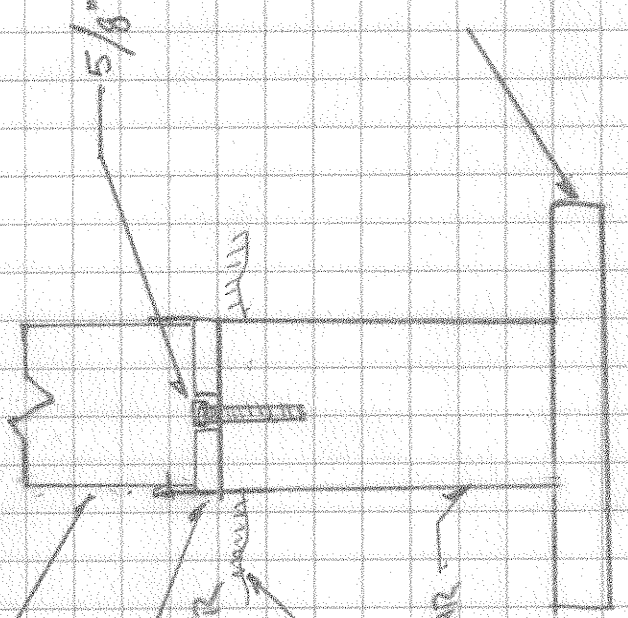

FOOTER  
24" DIA X 6" THICK