

NOTE:

1. ALL DIMENSIONS ARE REFERENCE ONLY. ALL DIMENSIONS SHALL BE FIELD VERIFIED BEFORE CONSTRUCTION BEGINS.
2. SEE STRUCTURAL DRAWINGS FOR HEADERS AT ALL NEW OR ENLARGED MASONRY OPENINGS.

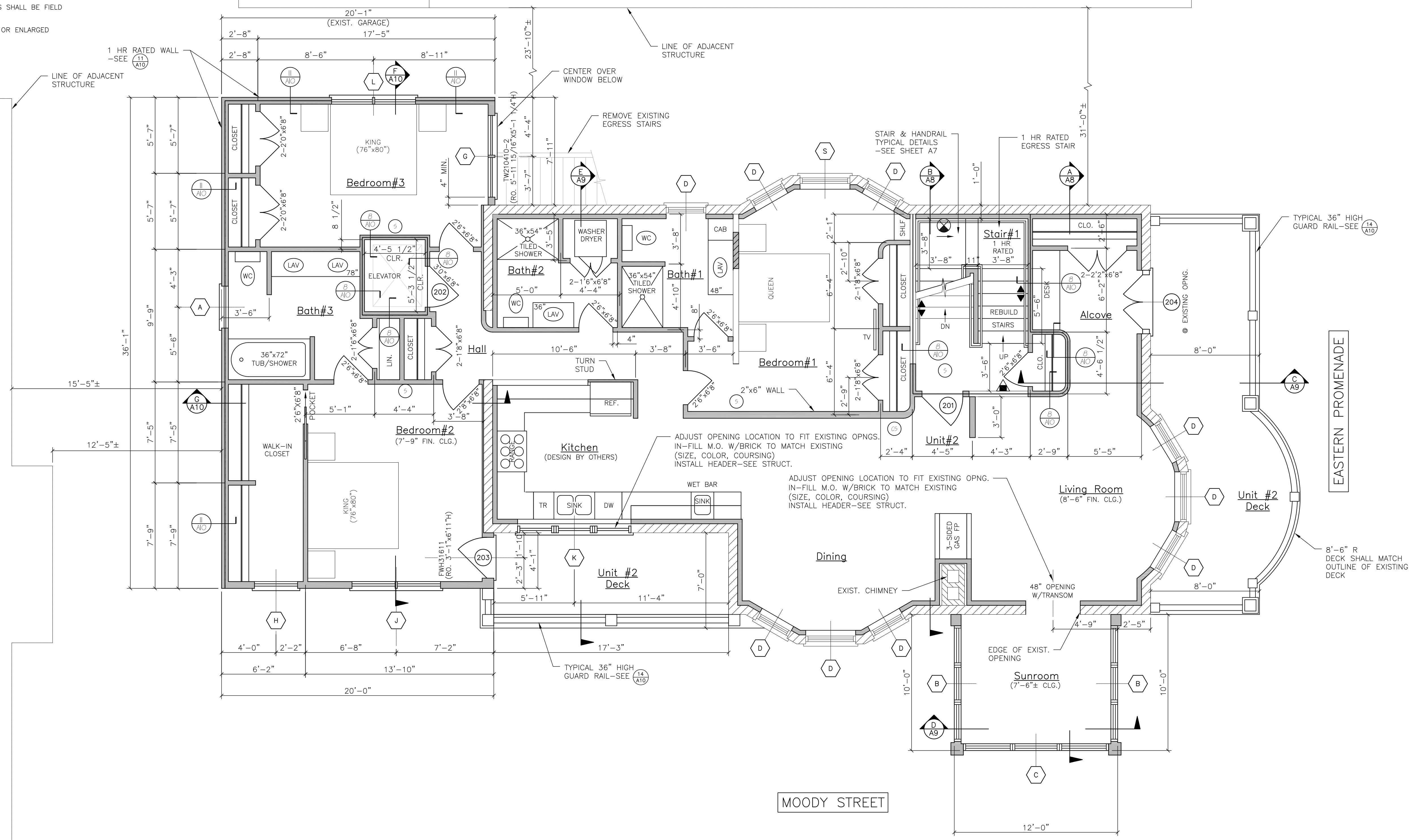

UNIT #2/SECOND FLOOR PLAN
SCALE: 1/4"=1'-0"

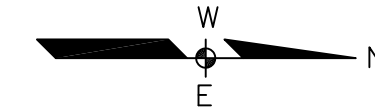

LEGEND	
SYMBOL	DESCRIPTION
[Solid line]	NEW WALL
[Dashed line]	NEW WALL/EXISTING WALL W/INFILL
[Thin solid line]	EXISTING WALL
[Thin line with dots]	THIN LINEWEIGHT DENOTES EXISTING CONDITIONS
[Thick solid line]	HEAVY LINEWEIGHT DENOTES NEW CONDITIONS
[Dotted line]	DEMOLISHED STRUCTURE
[Hatched area]	EXISTING MASONRY WALL

NFPA LEGEND	
[Circle with arrow]	EXIT LIGHT W/ DIRECTION ARROW
[Triangle with 'X']	FIRE EXTINGUISHER
[Square with 'E']	EMERGENCY LIGHT
[Circle with 'S']	SMOKE DETECTOR W/ SOUNDER BASE & STROBE (INTERCONNECTED)
[Circle with 'C']	COMBINATION CARBON MONOXIDE / SMOKE DETECTOR W/ SOUNDER BASE & STROBE (INTERCONNECTED)
[Circle with 'H']	HEAT DETECTOR
[Circle with 'R']	1 HR. FIRE RATED PARTITION

LIFE SAFETY NOTES

1. THE BUILDING SHALL HAVE AN NFPA FIRE SUPPRESSION SPRINKLER SYSTEM INSTALLED IN ACCORDANCE WITH NFPA LIFESAFETY CODE, 2009 INTERNATIONAL BUILDING CODE. SPRINKLER SYSTEM SHALL BE INSTALLED BY A CERTIFIED SPRINKLER CONTRACTOR AND SHALL BE REVIEWED AND APPROVED BY THE STATE OF MAINE FIRE MARSHAL AS WELL AS THE LOCAL AUTHORITY HAVING JURISDICTION. THE CONTRACTOR SHALL BEAR SOLE RESPONSIBILITY FOR THE DESIGN AND INSTALLATION OF THE SYSTEM FOR OCCUPANCY.
2. ALL ALARMS AND DETECTORS SHALL BE INTERCONNECTED WITHIN EACH LIVING UNIT.
3. REFER TO THE WINDOW SCHEDULE FOR EGRESS WINDOWS.

GENERAL NOTES

1. ALL HORIZONTAL UNIT SEPARATIONS (FLOOR/ CEILING/ ROOF) ASSEMBLIES SHALL BE 1 HR. FIRE RATED/ SIC 50.
-SEE (6) (A/C) & (10) (A/C) & (15) (A/C)
2. ALL VERTICAL UNIT SEPARATIONS (TENANT WALLS) SHALL BE 1 HR. FIRE RATED/ SIC 50.
-SEE (7) (A/C)
3. ALL STAIR ENCLOSURES SHALL BE 1 HR. FIRE RATED.
-SEE (1) (A/C) & (9) (A/C)
4. ELEVATOR SHAFT ENCLOSURE SHALL BE 2 HR. FIRE RATED.
-SEE (7) (A/C)
5. SEE SHEET A10 FOR STAIR DETAILS.
6. REMOVE EXISTING DECKS & FIRE ESCAPES IN THEIR ENTIRETY.

