

NFPA LEGEND	
	EXIT LIGHT
	FIRE EXTINGUISHER
	FIRE ALARM PULL MANUAL PULL STATION
	FIRE ALARM PANEL
	EMERGENCY LIGHT
	FIRE ALARM HORN STROBO UNIT
	FIRE ALARM STROBO UNIT
	SMOKE DETECTOR W/ SOUNDER BASE & STROBO (INTERCONNECTED)
	COMBINATION CARBON MONOXIDE / SMOKE DETECTOR W/ SOUNDER BASE & STROBO (INTERCONNECTED)
	HEAT DETECTOR
	KNOCK BOX
	1 HR FIRE RATED PARTITION
	2 HR FIRE RATED PARTITION

- ### LIFE SAFETY NOTES
- THE BUILDING SHALL HAVE AN NFPA 13R FIRE SUPPRESSION SPRINKLER SYSTEM INSTALLED IN ACCORDANCE WITH NFPA 101 LIFE SAFETY CODE, 2009 INTERNATIONAL BUILDING CODE. SPRINKLER SYSTEM SHALL BE INSTALLED BY A CERTIFIED SPRINKLER CONTRACTOR AND SHALL BE REVIEWED AND APPROVED BY THE STATE OF MAINE FIRE MARSHAL AS WELL AS THE LOCAL AUTHORITY HAVING JURISDICTION. THE CONTRACTOR SHALL BEAR SOLE RESPONSIBILITY FOR THE DESIGN AND INSTALLATION OF THE SYSTEM FOR OCCUPANCY.
 - THE BUILDING SHALL HAVE A FIRE ALARM SYSTEM AS REQUIRED FOR COMPLIANCE WITH NFPA 101 LIFE SAFETY CODE. COORDINATE WITH SPRINKLER SYSTEM. VERIFY LOCATION OF ALARM AND NOTIFICATION PANELS WITH THE AUTHORITY HAVING JURISDICTION.
 - ALL ALARMS AND DETECTORS SHALL BE INTERCONNECTED WITHIN EACH LIVING UNIT.
 - REFER TO THE WINDOW SCHEDULE FOR EGRESS WINDOWS.

- ### GENERAL NOTES
- ALL HORIZONTAL UNIT SEPARATIONS (FLOOR/CEILING/ROOF) ASSEMBLIES SHALL BE 1 HR. FIRE RATED / SIC 5.0.
 - SEE & &
 - ALL VERTICAL UNIT SEPARATIONS (TENANT WALLS) SHALL BE 1 HR. FIRE RATED / SIC 5.0.
 - SEE
 - ALL STAIR ENCLOSURES SHALL BE 1 HR. FIRE RATED.
 - SEE , ,
 - ELEVATOR SHAFT ENCLOSURE SHALL BE 2 HR. FIRE RATED.
 - SEE ,
 - SEE SHEET A10 FOR STAIR DETAILS.
 - REMOVE EXISTING DECKS & FIRE ESCAPES IN THEIR ENTIRETY.

- ### TYPE 5A FIRE RATED STRUCTURE NOTES 3 (MINIMUM 1 HR. RATING)
- ALL LOAD-BEARING WALLS
 - ALL STRUCTURAL POSTS/COLUMNS
 - ALL FLOOR ASSEMBLIES
 - ROOF STRUCTURE

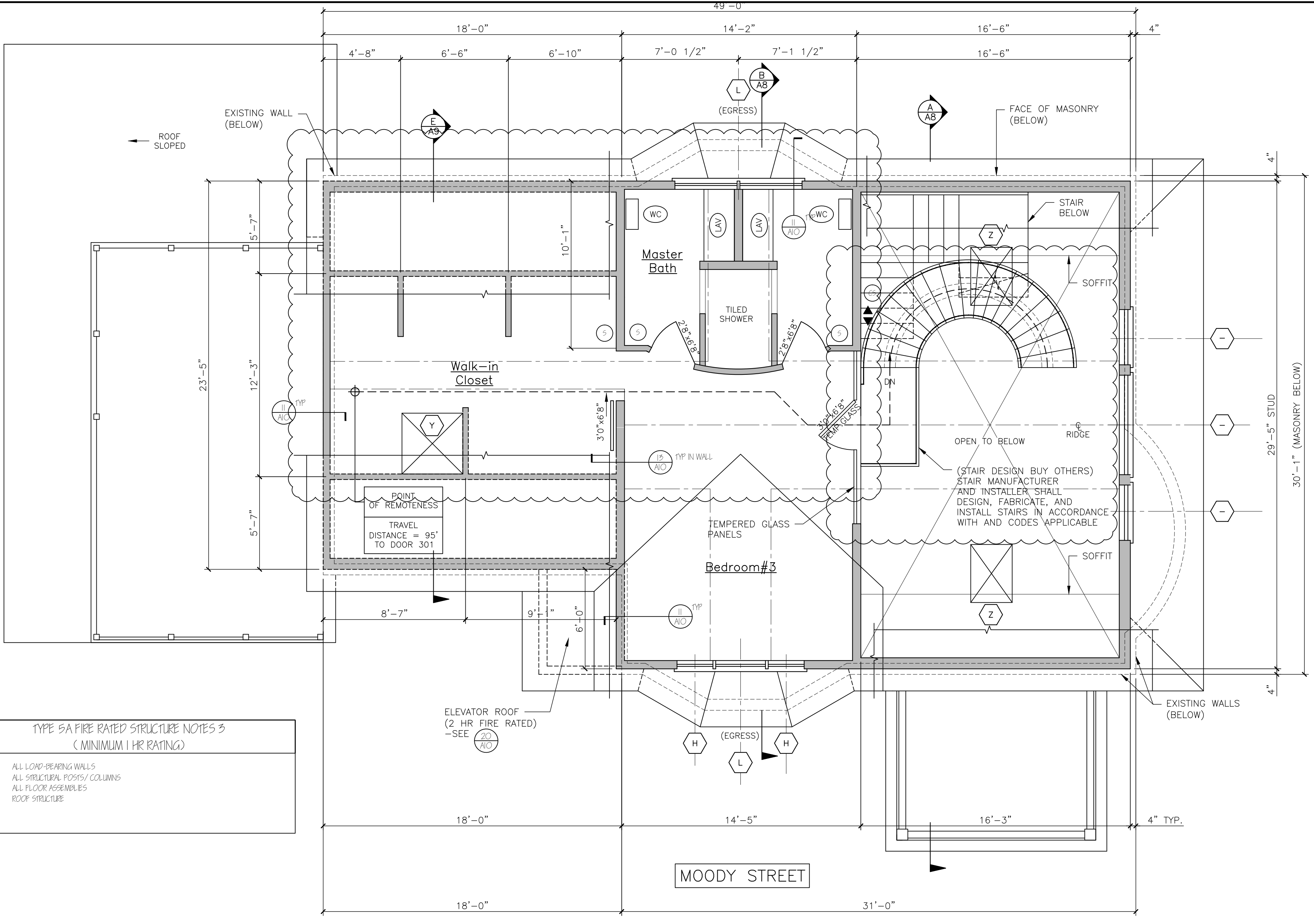

LEGEND	
	NEW WALL
	NEW WALL/EXISTING WALL W/INFILL
	EXISTING WALL
	THIN LINEWEIGHT DENOTES EXISTING CONDITIONS
	HEAVY LINEWEIGHT DENOTES NEW CONDITIONS
	DEMOLISHED STRUCTURE
	EXISTING MASONRY WALL

DOOR SCHEDULE						
NO.	SIZE (WxH)	INSUL.	FIRE RATING	HARDWARE	SWING	REMARKS
01	5'-0" x 6'-8"	NONE	1HR	HW-1	PER PLAN	* DOOR/FRAME ASSEMBLY, SELF CLOSING
02	5'-0" x 6'-8"	NONE	1HR	HW-1	PER PLAN	* DOOR/FRAME ASSEMBLY, SELF CLOSING
03	VERIFY M.O. IN FIELD	R-7	1HR	HW-2	PER PLAN	* DOOR/FRAME ASSEMBLY, SELF CLOSING
04	VERIFY M.O. IN FIELD	R-7	1HR	HW-2	PER PLAN	* DOOR/FRAME ASSEMBLY, SELF CLOSING
05	VERIFY M.O. IN FIELD	R-7	1HR	HW-2	PER PLAN	* DOOR/FRAME ASSEMBLY, SELF CLOSING, WITH SIDE LITE, 3/4 VIEW DOOR LITE
06	5'-0" x 6'-8"	R-7	1HR	HW-2	PER PLAN	* DOOR/FRAME ASSEMBLY, SELF CLOSING
07	2'-6" x 6'-8"	NONE	1HR	HW-5	PER PLAN	* DOOR/FRAME ASSEMBLY, SELF CLOSING
08	5'-0" x 6'-8"	R-7	2HR	MGR	PER PLAN	* DOOR/FRAME ASSEMBLY, SELF CLOSING @ ELEVATOR, VERIFY OPENING LOCATION WITH ELEVATOR
09	8'-0" x 7'-0"	R-7	NONE	-	PER PLAN	GARAGE DOOR - FIELD VERIFY SIZE, DOOR OPERATOR, VERIFY M.O. IN FIELD
10	8'-0" x 7'-0"	R-7	NONE	-	PER PLAN	GARAGE DOOR - FIELD VERIFY SIZE, DOOR OPERATOR, VERIFY M.O. IN FIELD
11	5'-11" x 8'-0"	R-7	NONE	-	PER PLAN	ATTIUM-ANDERSEN OR EQUIV. (RD. 5'-11" x 8'-0")
12	5'-0" x 6'-8"	R-7	1HR	HW-1	PER PLAN	* DOOR/FRAME ASSEMBLY, SELF CLOSING
13	5'-0" x 6'-8"	NONE	1HR	HW-1	PER PLAN	* DOOR/FRAME ASSEMBLY, SELF CLOSING
14	5'-0" x 6'-8"	NONE	2HR	MGR	PER PLAN	* DOOR/FRAME ASSEMBLY, SELF CLOSING @ ELEVATOR
15	5'-11" x 6'-11"	R-7	NONE	-	FIXED	ATTIUM-ANDERSEN OR EQUIV. (RD. 5'-11" x 6'-11") VERIFY M.O. IN FIELD
16	4'-11" x 6'-11"	R-7	NONE	-	PER PLAN	ATTIUM-ANDERSEN OR EQUIV. (RD. 4'-11" x 6'-11") VERIFY M.O. IN FIELD
17	5'-0" x 6'-8"	NONE	1HR	HW-1	PER PLAN	* DOOR/FRAME ASSEMBLY, SELF CLOSING
18	4'-11" x 6'-11"	R-7	NONE	-	PER PLAN	ATTIUM-ANDERSEN OR EQUIV. (RD. 4'-11" x 6'-11")
19	5'-11" x 6'-11"	R-7	NONE	-	PER PLAN	ATTIUM-ANDERSEN OR EQUIV. (RD. 5'-11" x 6'-11")

NOTE: SEE FLOOR PLANS FOR UNIT INTERIOR DOOR SIZES, SWING AND TYPE		
HW-1	3 BUTTS*, STORE ROOM LEVER LOCKSET	* CC OPTION: SELF CLOSING BUTTS OR DOOR CLOSER
HW-2	3 BUTTS*, DOOR ENTRY LEVEL LOCKSET, THRESHOLD WEATHER STRIPPING, DOOR BOTTOM, DOOR VIEWER	* CC OPTION: SELF CLOSING BUTTS OR DOOR CLOSER
HW-5	3 BUTTS*, DOOR ENTRY LEVEL LOCKSET, THRESHOLD WEATHER STRIPPING, DOOR BOTTOM	* CC OPTION: SELF CLOSING BUTTS OR DOOR CLOSER
MGR	PER RESIDENTIAL ELEVATOR MANUFACTURER- 2 HR FIRE RATING	
HW-4	3 BUTTS*, LEVER LATCH SET (PASSAGE)	* CC OPTION: SELF CLOSING BUTTS OR DOOR CLOSER

UNIT #3/FOURTH FLOOR PLAN
SCALE: 1/4"=1'-0"

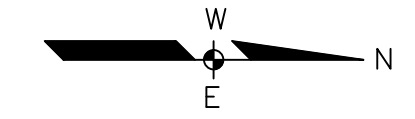

WINDOW SCHEDULE						
NO.	SIZE (WxH) OR UNIT NO.	TYPE	FIRE RATING	GLAZING	ROUGH OPENING (WxH)	REMARKS
A	AW21	AWNING	NONE	INSUL. GL.	5'-0 1/2" x 5'-0 1/2"	ANDERSEN OR EQUIV., INFILL MASONRY OPENING
B	TW2810-5	DOUBLE-HUNG	NONE	INSUL. GL.	8'-5 5/8" x 4'-6 1/4"	ANDERSEN OR EQUIV.
C	TW2410-5	DOUBLE-HUNG	NONE	INSUL. GL.	10'-5 3/4" x 4'-6 1/4"	ANDERSEN OR EQUIV., (EGRESS WINDOW)
D	REPLACEMENT WINDOW-MATCH EXISTING SIZE	DOUBLE-HUNG	NONE	INSUL. GL.	VERIFY M.O. / R.O. IN FIELD	ANDERSEN REPLACEMENT WINDOW OR EQUIV.
E	TW2410	DOUBLE-HUNG	NONE	INSUL. GL.	2'-6 1/8" x 4'-11 1/4"	ANDERSEN OR EQUIV.
F	AW21	AWNING	NONE	INSUL. GL.	2'-4 7/8" x 4'-7 7/8"	ANDERSEN OR EQUIV., INFILL MASONRY OPENING
G	TW210410-2	DOUBLE-HUNG	NONE	INSUL. GL.	5'-11 1/8" x 4'-11 1/4"	ANDERSEN OR EQUIV., (EGRESS WINDOW)
H	TW2046	DOUBLE-HUNG	NONE	INSUL. GL.	5'-2 1/8" x 4'-9 1/4"	ANDERSEN OR EQUIV., (EGRESS WINDOW)
I	TW2046-2	DOUBLE-HUNG	NONE	INSUL. GL.	6'-4 1/4" x 4'-9 1/4"	ANDERSEN OR EQUIV., (EGRESS WINDOW)
J	REPLACEMENT WINDOW-(5) 52" x 36"	AWNING	NONE	TEMP. INSUL. GL.	VERIFY M.O. IN FIELD	ANDERSEN REPLACEMENT WINDOW OR EQUIV., INFILL MASONRY OPENING, INSTALL HEADER
K	TW2052	DOUBLE-HUNG	NONE	INSUL. GL.	5'-2 1/8" x 4'-7 7/8"	ANDERSEN OR EQUIV., (EGRESS WINDOW)
L	TW2046-2PH31046-TW2046	DOUBLE-HUNG/PICTURE	NONE	INSUL. GL.	TO BE DETERMINED	ANDERSEN OR EQUIV., (EGRESS WINDOW)
M	CW155-PS055-CW155	CASEMENT/PICTURE	NONE	INSUL. GL.	VERIFY R.O. IN FIELD	ANDERSEN OR EQUIV.
N	PH21042	PICTURE	NONE	TEMP. INSUL. GL.	5'-11 7/8" x 4'-9 1/4"	ANDERSEN OR EQUIV.
O	TW2442	DOUBLE-HUNG	NONE	TEMP. INSUL. GL.	2'-6 1/8" x 4'-9 1/4"	ANDERSEN OR EQUIV.
P	TW2410	DOUBLE-HUNG	NONE	TEMP. INSUL. GL.	2'-6 1/8" x 4'-11 1/4"	ANDERSEN OR EQUIV.
Q	REPLACEMENT WINDOW-MATCH EXISTING SIZE	DOUBLE-HUNG	NONE	TEMP. INSUL. GL.	18"D. IN FIELD	ANDERSEN REPLACEMENT WINDOW OR EQUIV., (EGRESS WINDOW)
R	CR20	CIRCULAR	NONE	INSUL. GL.	2'-0 5/8" x 2'-0 5/8"	ANDERSEN OR EQUIV.
S	REPLACEMENT WINDOW	FIXED	NONE	TEMP. INSUL. GL.	VERIFY M.O. IN FIELD	EXISTING WINDOW TO REMAIN AND SINGLE GLAZING STORM SASH (TEMPERED)
T	REPLACEMENT WINDOW-CASEMENT	AWNING	NONE	INSUL. GL.	VERIFY M.O. IN FIELD	ANDERSEN REPLACEMENT WINDOW OR EQUIV., (EGRESS WINDOW)
U	REPLACEMENT WINDOW-MATCH EXISTING SIZE	PICTURE	NONE	TEMP. INSUL. GL.	VERIFY M.O. IN FIELD	ANDERSEN REPLACEMENT WINDOW OR EQUIV., (TEMPERED)
V	TW2056	DOUBLE-HUNG	NONE	TEMP. INSUL. GL.	2'-2 1/8" x 5'-8 7/8"	ANDERSEN OR EQUIV.

DOOR SCHEDULE & HARDWARE SETS

WINDOW SCHEDULE

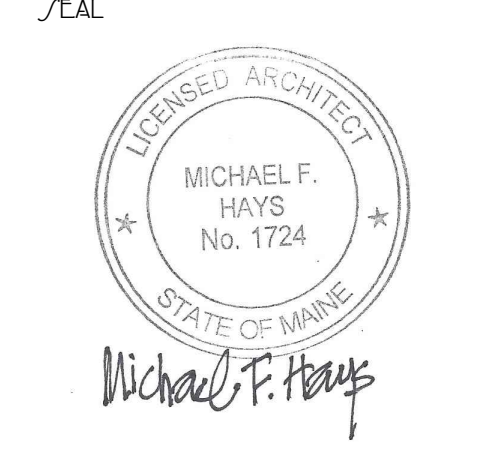

REVISION	DATE	DESCRIPTION
1	06.29.2017	FIRE ALARM SYSTEM
2	08.01.2017	EDITS PER PLAN REVIEW
3	12.14.2017	ADDED 58D FILE, SUNROOM & PORCH, PLAN EDITS

PROJECT NAME

3 UNIT APARTMENT BUILDING
162 EASTERN PROMENADE
162 EASTERN PROMENADE LLC.
162 EASTERN PROMENADE
PORTLAND, MAINE 04101

UNIT #3 FOURTH FLOOR PLAN
& DOOR & WINDOW SCHEDULE

DATE: 19 OCT 2015
SCALE: 1/4"=1'-0"
DRAWN BY: JAM/MFH
JOB NO.: 150815