

**GRANT HAYS ASSOCIATES**  
 ARCHITECTURE & INTERIOR DESIGN  
 P.O. BOX 6179 FALMOUTH MAINE 04105  
 207.871.5900 www.granthays.com

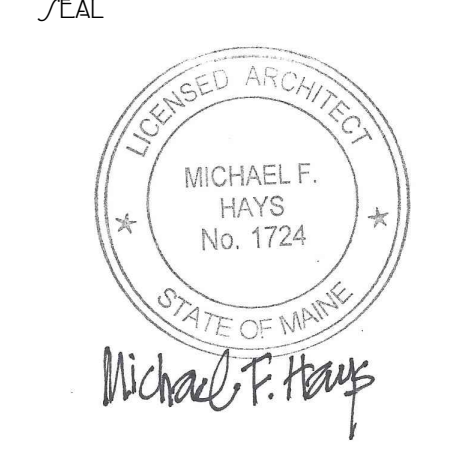

REVISIONS  
 12.23.2015  
 09.09.2017  
 06.29.2017 FIRE ALARM SYSTEM  
 08.01.2017 ERTS PER PLAN REVIEW

PROJECT NAME

**3 UNIT APARTMENT BUILDING**  
**162 EASTERN PROMENADE**  
 162 EASTERN PROMENADE L.L.C.  
 162 EASTERN PROMENADE  
 PORTLAND, MAINE 04101

UNIT #3 THIRD FLOOR PLAN  
 DATE: 19 OCT 2015  
 SCALE: 1/4"=1'-0"  
 DRAWN: JAM/MFH  
 JOB NO: 150815

**A7**  
 COPYRIGHT REPRODUCTION OR RELIANCE OF THIS DOCUMENT WITHOUT WRITTEN PERMISSION FROM GRANT HAYS ASSOCIATES IS PROHIBITED.

**NFPA LEGEND**

⊗	EXIT LIGHT
▲	FIRE EXTINGUISHER
F	FIRE ALARM PULL MANUAL PULL STATION
FACP	FIRE ALARM PANEL
⬅	EMERGENCY LIGHT
⊠	FIRE ALARM HORN STROBE UNIT
⊡	FIRE ALARM STROBE UNIT
S	SMOKE DETECTOR W/ SOUNDER BASE & STROBE (INTERCONNECTED)
CS	COMBINATION CARBON MONOXIDE / SMOKE DETECTOR W/ SOUNDER BASE & STROBE (INTERCONNECTED)
H	HEAT DETECTOR
K	KNOX BOX
---	1 HR FIRE RATED PARTITION
---	2 HR FIRE RATED PARTITION

- NOTE:**
- ALL DIMENSIONS ARE REFERENCE ONLY. ALL DIMENSIONS SHALL BE FIELD VERIFIED BEFORE CONSTRUCTION BEGINS.
  - SEE STRUCTURAL DRAWINGS FOR HEADERS AT ALL NEW OR ENLARGED MASONRY OPENINGS.

**LEGEND**

SYMBOL	DESCRIPTION
---	NEW WALL
---	NEW WALL/EXISTING WALL W/INFILL
---	EXISTING WALL
---	THIN LINEWEIGHT DENOTES EXISTING CONDITIONS
---	HEAVY LINEWEIGHT DENOTES NEW CONDITIONS
---	DEMOLISHED STRUCTURE
---	EXISTING MASONRY WALL

**LIFE SAFETY NOTES**

- THE BUILDING SHALL HAVE AN NFPA 13R FIRE SUPPRESSION SPRINKLER SYSTEM INSTALLED IN ACCORDANCE WITH NFPA 101 LIFE SAFETY CODE, 2009 INTERNATIONAL BUILDING CODE. SPRINKLER SYSTEM SHALL BE INSTALLED BY A CERTIFIED SPRINKLER CONTRACTOR AND SHALL BE REVIEWED AND APPROVED BY THE STATE OF MAINE FIRE MARSHAL AS WELL AS THE LOCAL AUTHORITY HAVING JURISDICTION. THE CONTRACTOR SHALL BEAR SOLE RESPONSIBILITY FOR THE DESIGN AND INSTALLATION OF THE SYSTEM FOR OCCUPANCY.
- THE BUILDING SHALL HAVE A FIRE ALARM SYSTEM AS REQUIRED FOR COMPLIANCE WITH NFPA 101 LIFE SAFETY CODE COORDINATE WITH SPRINKLER SYSTEM. VERIFY LOCATION OF ALARM AND NOTIFICATION PANELS WITH THE AUTHORITY HAVING JURISDICTION.
- ALL ALARMS AND DETECTORS SHALL BE INTERCONNECTED WITHIN EACH LIVING UNIT.
- REFER TO THE WINDOW SCHEDULE FOR EGRESS WINDOWS.

**GENERAL NOTES**

- ALL HORIZONTAL UNIT SEPARATIONS (FLOOR/CEILING/ROOF) ASSEMBLIES SHALL BE 1 HR. FIRE RATED/ 5/15 G.O.  
 -SEE 6 A/C, 10 A/C & 14 A/C
- ALL VERTICAL UNIT SEPARATIONS (TENANT WALLS) SHALL BE 1 HR. FIRE RATED/ 5/15 G.O.  
 -SEE 7 A/C
- ALL STAIR ENCLOSURES SHALL BE 1 HR. FIRE RATED  
 -SEE 6 A/C, 8 A/C, 10 A/C
- ELEVATOR SHAFT ENCLOSURE SHALL BE 2 HR. FIRE RATED  
 -SEE 18 A/C, 20 A/C
- SEE SHEET A10 FOR STAIR DETAILS
- REMOVE EXISTING DECKS & FIRE ESCAPES IN THEIR ENTIRETY.

**TYPE 5A FIRE RATED STRUCTURE NOTES 3 (MINIMUM 1 HR RATING)**

- ALL LOAD-BEARING WALLS
- ALL STRUCTURAL POSTS/ COLUMNS
- ALL FLOOR ASSEMBLIES
- ROOF STRUCTURE

**DOOR SCHEDULE**

NO.	SIZE (WxH)	INSUL.	FIRE RATING	HARDWARE	SWING	REMARKS
001	5'-0"x6'-8"	NONE	1HR	HW-1	PER PLAN	* DOOR/ FRAME ASSEMBLY, SELF CLOSING
002	5'-0"x6'-8"	NONE	1HR	HW-1	PER PLAN	* DOOR/ FRAME ASSEMBLY, SELF CLOSING
003	VERIFY M.O. IN FIELD	R-7	1HR	HW-2	PER PLAN	* DOOR/ FRAME ASSEMBLY, SELF CLOSING
004	VERIFY M.O. IN FIELD	R-7	1HR	HW-2	PER PLAN	* DOOR/ FRAME ASSEMBLY, SELF CLOSING
005	VERIFY M.O. IN FIELD	R-7	1HR	HW-2	PER PLAN	* DOOR/ FRAME ASSEMBLY, SELF CLOSING; WITH SIDE LITE, 3/4 VIEW DOOR LITE
006	5'-0"x6'-8"	R-7	1HR	HW-2	PER PLAN	* DOOR/ FRAME ASSEMBLY, SELF CLOSING
007	5'-0"x6'-8"	R-7	1HR	HW-5	PER PLAN	* DOOR/ FRAME ASSEMBLY, SELF CLOSING
008	5'-0"x6'-8"	R-7	2HR	MGR	PER PLAN	* DOOR/ FRAME ASSEMBLY, SELF CLOSING @ ELEVATOR; VERIFY OPENING LOCATION WITH ELEVATOR
009	8'-0"x7'-0"	R-7	NONE	-	PER PLAN	GARAGE DOOR - FIELD VERIFY SIZE, DOOR OPERATOR, VERIFY M.O. IN FIELD
010	8'-0"x7'-0"	R-7	NONE	-	PER PLAN	GARAGE DOOR - FIELD VERIFY SIZE, DOOR OPERATOR, VERIFY M.O. IN FIELD
011	5'-11"x8'-0"	R-7	NONE	-	PER PLAN	ARRIUM-ANDERSEN OR EQUIV. (RD. 5'-11"x8'-0")
012	5'-0"x6'-8"	R-7	1HR	HW-1	PER PLAN	* DOOR/ FRAME ASSEMBLY, SELF CLOSING
013	5'-0"x6'-8"	NONE	1HR	HW-1	PER PLAN	* DOOR/ FRAME ASSEMBLY, SELF CLOSING
014	5'-0"x6'-8"	NONE	2HR	MGR	PER PLAN	* DOOR/ FRAME ASSEMBLY, SELF CLOSING @ ELEVATOR
015	5'-11"x6'-11"	R-7	NONE	-	FIXED	ARRIUM-ANDERSEN OR EQUIV. (RD. 5'-11"x6'-11") VERIFY M.O. IN FIELD
016	4'-11"x6'-11"	R-7	NONE	-	PER PLAN	ARRIUM-ANDERSEN OR EQUIV. (RD. 4'-11"x6'-11") VERIFY M.O. IN FIELD
017	5'-0"x6'-8"	NONE	1HR	HW-1	PER PLAN	* DOOR/ FRAME ASSEMBLY, SELF CLOSING
018	4'-11"x6'-11"	R-7	NONE	-	PER PLAN	ARRIUM-ANDERSEN OR EQUIV. (RD. 4'-11"x6'-11")
019	4'-11"x6'-11"	R-7	NONE	-	PER PLAN	ARRIUM-ANDERSEN OR EQUIV. (RD. 4'-11"x6'-11")

**NOTE: SEE FLOOR PLANS FOR UNIT INTERIOR DOOR SIZES, SWING AND TYPE**

HW-1	3 BUTTS*, STORE ROOM LEVER LOCKSET	* GC OPTION: SELF CLOSING BUTTS OR DOOR CLOSER
HW-2	3 BUTTS*, DOOR ENTRY LEVEL LOCKSET, THRESHOLD WEATHER STRIPPING, DOOR BOTTOM, DOOR VIEWER	* GC OPTION: SELF CLOSING BUTTS OR DOOR CLOSER
HW-5	3 BUTTS*, DOOR ENTRY LEVEL LOCKSET, THRESHOLD WEATHER STRIPPING, DOOR BOTTOM	* GC OPTION: SELF CLOSING BUTTS OR DOOR CLOSER
MGR	PER RESIDENTIAL ELEVATOR MANUFACTURER- 2 HR FIRE RATING	
HW-4	3 BUTTS*, LEVER LATCH SET (PASSAGE)	* GC OPTION: SELF CLOSING BUTTS OR DOOR CLOSER

DOOR SCHEDULE & HARDWARE SETS

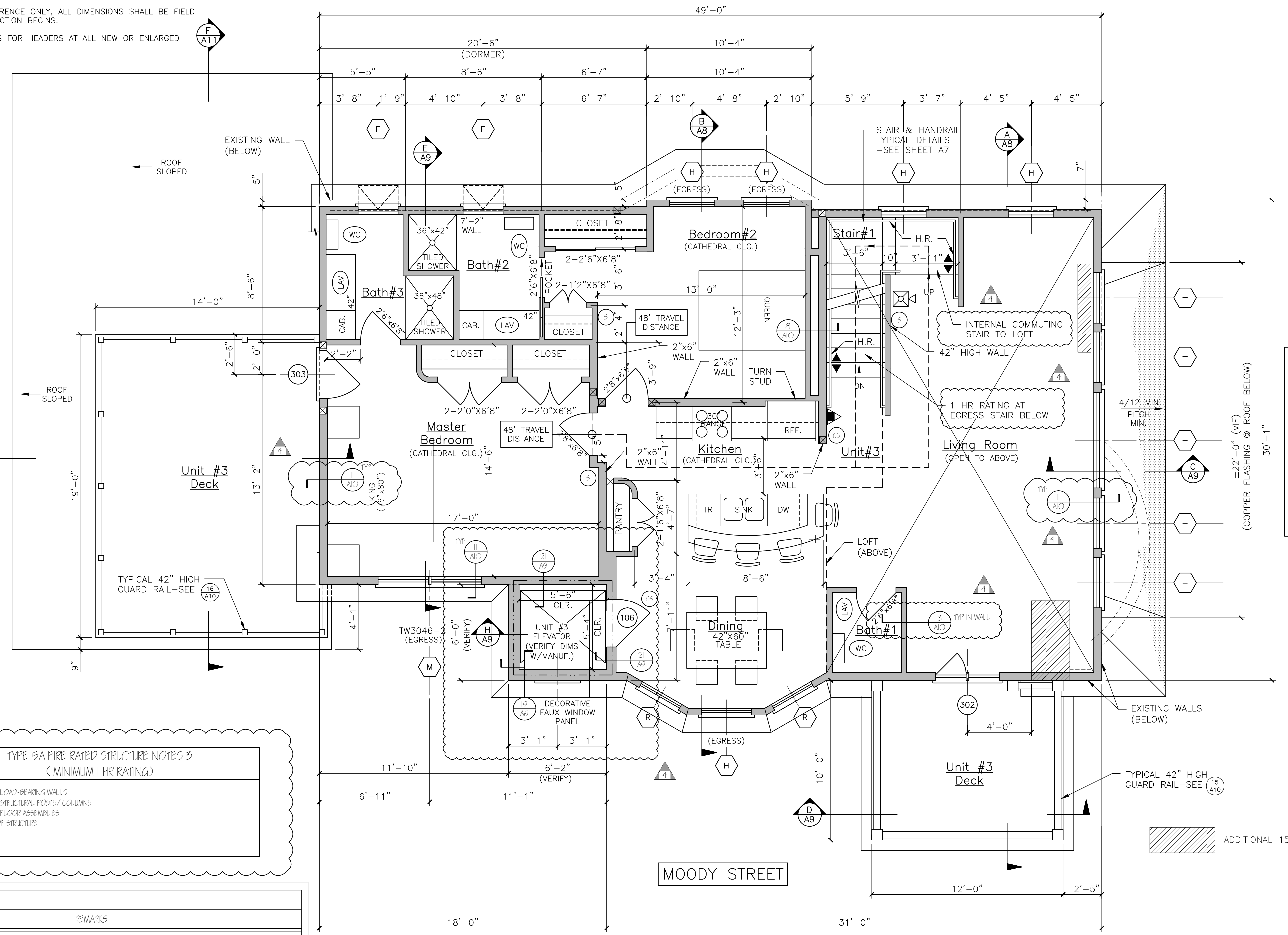

**UNIT #3/THIRD FLOOR PLAN**  
 SCALE: 1/4"=1'-0"

**WINDOW SCHEDULE**

NO.	SIZE (WxD) OR UNIT NO.	TYPE	FIRE RATING	GLAZING	ROUGH OPENING (WxD)	REMARKS
A	AW51	AWNING	NONE	INSUL. GL.	5'-0 1/2" x 5'-0 1/2"	ANDERSEN OR EQUIV., INFILL MASONRY OPENING
B	TW2810-5	DOUBLE-HUNG	NONE	INSUL. GL.	8'-5 5/8" x 4'6"-11/4"	ANDERSEN OR EQUIV.
C	TW5410-5	DOUBLE-HUNG	NONE	INSUL. GL.	10'-5 5/8" x 4'6"-11/4"	ANDERSEN OR EQUIV., (EGRESS WINDOW)
D	REPLACEMENT WINDOW-MATCH EXISTING SIZE	DOUBLE-HUNG	NONE	INSUL. GL.	VERIFY M.O. IN FIELD	ANDERSEN REPLACEMENT WINDOW OR EQUIV.
E	TW2410	DOUBLE-HUNG	NONE	INSUL. GL.	2'-6 1/8" x 6'-11/4"	ANDERSEN OR EQUIV.
F	AW251	AWNING	NONE	INSUL. GL.	2'-4 7/8" x 2'-4 7/8"	ANDERSEN OR EQUIV., INFILL MASONRY OPENING
G	TW2010-2	DOUBLE-HUNG	NONE	INSUL. GL.	5'-11 1/8" x 6'-11/4"	ANDERSEN OR EQUIV., (EGRESS WINDOW)
H	TW5046	DOUBLE-HUNG	NONE	INSUL. GL.	5'-2 1/8" x 4'-9 1/4"	ANDERSEN OR EQUIV., (EGRESS WINDOW)
I	TW5046-2	DOUBLE-HUNG	NONE	INSUL. GL.	6'-4 1/4" x 9 1/4"	ANDERSEN OR EQUIV., (EGRESS WINDOW)
J	REPLACEMENT WINDOW-(5) 92"x56"	AWNING	NONE	TEMP. INSUL. GL.	VERIFY M.O. IN FIELD	ANDERSEN REPLACEMENT WINDOW OR EQUIV., INFILL MASONRY OPENING, INSTALL HEADER
K	TW5046-RP21046-TW5046	DOUBLE-HUNG/PICTURE	NONE	INSUL. GL.	TO BE DETERMINED	ANDERSEN OR EQUIV., (EGRESS WINDOW)
L	CM159-PS059-CM159	CASEMENT/PICTURE	NONE	INSUL. GL.	VERIFY R.O. IN FIELD	ANDERSEN OR EQUIV.
M	RP21042	PICTURE	NONE	TEMP. INSUL. GL.	5'-11 7/8" x 4'-9 1/4"	ANDERSEN OR EQUIV.
N	TW2442	DOUBLE-HUNG	NONE	TEMP. INSUL. GL.	2'-6 1/4" x 4'-9 1/4"	ANDERSEN OR EQUIV.
O	TW2410	DOUBLE-HUNG	NONE	TEMP. INSUL. GL.	2'-6 1/8" x 4'-11/4"	ANDERSEN OR EQUIV.
P	REPLACEMENT WINDOW-MATCH EXISTING SIZE	DOUBLE-HUNG	NONE	TEMP. INSUL. GL.	TBD IN FIELD	ANDERSEN REPLACEMENT WINDOW OR EQUIV., (EGRESS WINDOW)
Q	CR20	CIRCULAR	NONE	INSUL. GL.	2'-0 5/8" x 2'-0 5/8"	ANDERSEN OR EQUIV.
R	REPLACEMENT WINDOW	FIXED	NONE	TEMP. INSUL. GL.	VERIFY M.O. IN FIELD	EXISTING WINDOW TO REMAIN ADD SINGLE GLAZING STORM SASH (TEMPERED)
S	REPLACEMENT WINDOW-BASMENT	AWNING	NONE	INSUL. GL.	VERIFY M.O. IN FIELD	ANDERSEN REPLACEMENT WINDOW OR EQUIV., (EGRESS WINDOW)
T	REPLACEMENT WINDOW-MATCH EXISTING SIZE	PICTURE	NONE	TEMP. INSUL. GL.	VERIFY M.O. IN FIELD	ANDERSEN REPLACEMENT WINDOW OR EQUIV., (TEMPERED)

WINDOW SCHEDULE