

- NOTE:
- ALL DIMENSIONS ARE REFERENCE ONLY. ALL DIMENSIONS SHALL BE FIELD VERIFIED BEFORE CONSTRUCTION BEGINS.
  - SEE STRUCTURAL DRAWINGS FOR HEADERS AT ALL NEW OR ENLARGED MASONRY OPENINGS.

**NFPA LEGEND**

	EXIT LIGHT W/ DIRECTION ARROW
	FIRE EXTINGUISHER
	EMERGENCY LIGHT
	SMOKE DETECTOR W/ SOUNDER BASE & STROBE (INTERCONNECTED)
	CARBON MONOXIDE / SMOKE DETECTOR W/ SOUNDER BASE & STROBE (INTERCONNECTED)
	HEAT DETECTOR
	1 HR FIRE RATED PARTITION

**LIFE SAFETY NOTES**

- THE BUILDING SHALL HAVE AN NFPA 13R FIRE SUPPRESSION SPRINKLER SYSTEM INSTALLED IN ACCORDANCE WITH NFPA 101 LIFE SAFETY CODE, 2009 INTERNATIONAL BUILDING CODE. SPRINKLER SYSTEM SHALL BE INSTALLED BY A CERTIFIED SPRINKLER CONTRACTOR AND SHALL BE REVIEWED AND APPROVED BY THE STATE OF MAINE FIRE MARSHAL AS WELL AS THE LOCAL AUTHORITY HAVING JURISDICTION. THE CONTRACTOR SHALL BEAR SOLE RESPONSIBILITY FOR THE DESIGN AND INSTALLATION OF THE SYSTEM FOR OCCUPANCY.
- ALL ALARMS AND DETECTORS SHALL BE INTERCONNECTED WITHIN EACH LIVING UNIT.
- REFER TO THE WINDOW SCHEDULE FOR EGRESS WINDOWS.

**GENERAL NOTES**

- ALL HORIZONTAL UNIT SEPARATIONS (FLOOR/CEILING/ROOF) ASSEMBLIES SHALL BE 1 HR. FIRE RATED / SIC 50.
  - SEE (6/10) & (10/15)
- ALL VERTICAL UNIT SEPARATIONS (TENANT WALLS) SHALL BE 1 HR. FIRE RATED / SIC 50.
  - SEE (7/10)
- ALL STAIR ENCLOSURES SHALL BE 1 HR. FIRE RATED.
  - SEE (1/10) & (2/10)
- ELEVATOR SHAFT ENCLOSURE SHALL BE 2 HR. FIRE RATED.
  - SEE (7/10)
- SEE SHEET A10 FOR STAIR DETAILS.
- REMOVE EXISTING DECKS & FIRE ESCAPES IN THEIR ENTIRETY.

**LEGEND**

SYMBOL	DESCRIPTION
	NEW WALL
	NEW WALL/EXISTING WALL W/INFILL
	EXISTING WALL
	THIN LINEWEIGHT DENOTES EXISTING CONDITIONS
	HEAVY LINEWEIGHT DENOTES NEW CONDITIONS
	DEMOLISHED STRUCTURE
	EXISTING MASONRY WALL

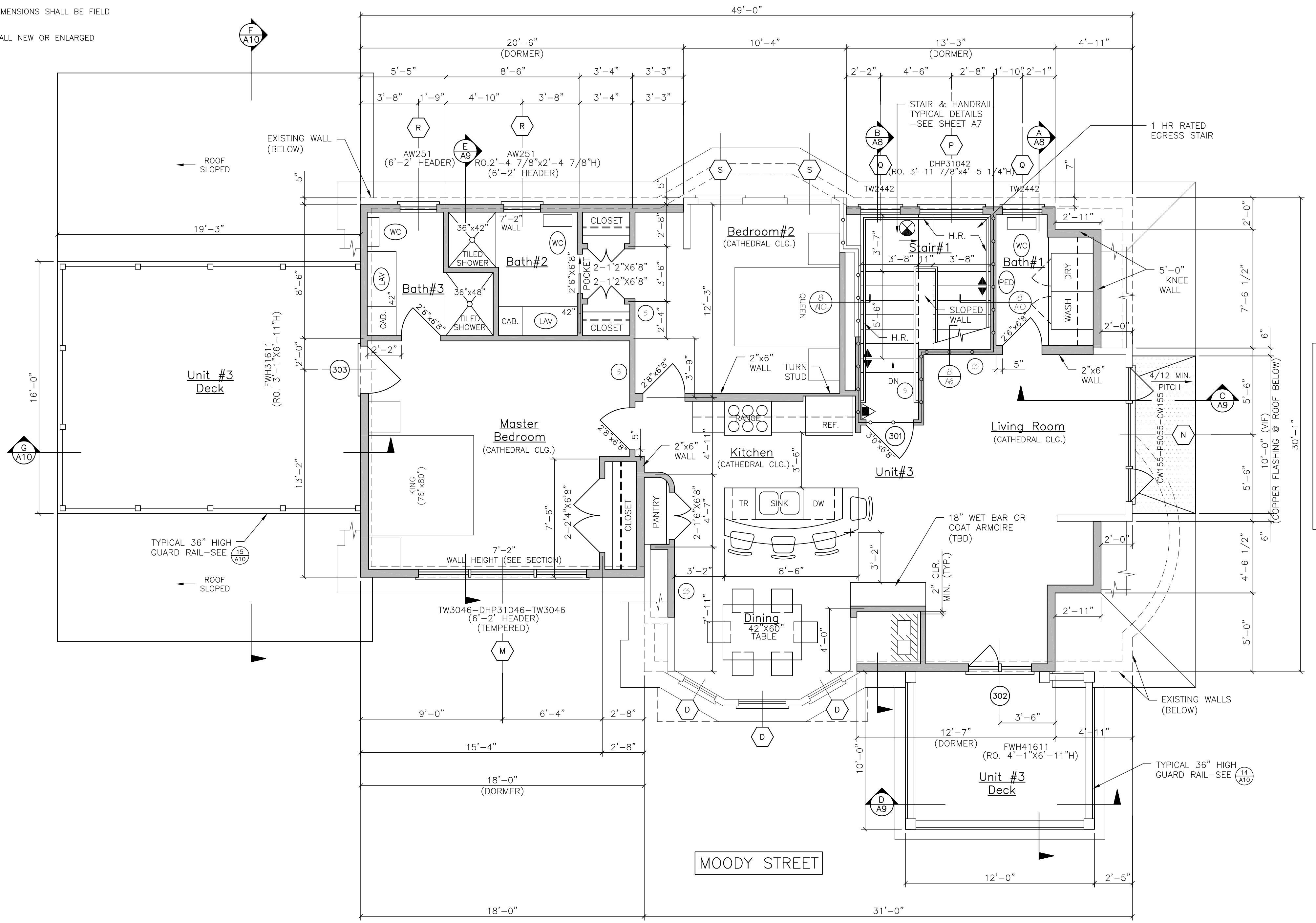

UNIT #3/THIRD FLOOR PLAN  
SCALE: 1/4"=1'-0"

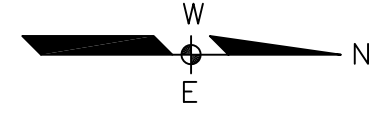

**DOOR SCHEDULE**

NO.	SIZE (WxH)	INSUL.	FIRE RATING	HARDWARE	SWING	REMARKS
01	3'-0"x6'-8"	NONE	1 HR	HW-1	PER PLAN	* DOOR/FRAME ASSEMBLY, SELF CLOSING
02	VERIFY M.O. IN FIELD	R-7	1 HR	HW-2	PER PLAN	* DOOR/FRAME ASSEMBLY, SELF CLOSING
03	VERIFY M.O. IN FIELD	R-7	1 HR	HW-2	PER PLAN	* DOOR/FRAME ASSEMBLY, SELF CLOSING
04	VERIFY M.O. IN FIELD	R-7	1 HR	HW-2	PER PLAN	* DOOR/FRAME ASSEMBLY, SELF CLOSING WITH SIDE LITE: 3/4 VIEW DOOR LITE
05	3'-0"x6'-8"	R-7	1 HR	HW-2	PER PLAN	* DOOR/FRAME ASSEMBLY, SELF CLOSING
06	2'-6"x6'-8"	NONE	1 HR	HW-5	PER PLAN	* DOOR/FRAME ASSEMBLY, SELF CLOSING
07	3'-0"x6'-8"	R-7	2 HR	MFG	PER PLAN	* DOOR/FRAME ASSEMBLY, SELF CLOSING @ ELEVATOR; VERIFY OPENING LOCATION WITH ELEVATOR
08	8'-0"x7'-0"	R-7	NONE	-	PER PLAN	GARAGE DOOR - FIELD VERIFY SIZE, DOOR OPENER, VERIFY M.O. IN FIELD
09	8'-0"x7'-0"	R-7	NONE	-	PER PLAN	GARAGE DOOR - FIELD VERIFY SIZE, DOOR OPENER, VERIFY M.O. IN FIELD
10	3'-1"x6'-0"	R-7	NONE	-	PER PLAN	ARTIUM-ANDERSEN OR EQUIV. (RO. 3'-1"x6'-0")
11	3'-0"x6'-8"	NONE	1 HR	HW-1	PER PLAN	* DOOR/FRAME ASSEMBLY, SELF CLOSING
12	3'-0"x6'-8"	NONE	2 HR	MFG	PER PLAN	* DOOR/FRAME ASSEMBLY, SELF CLOSING @ ELEVATOR
13	3'-1"x6'-11"	R-7	NONE	-	PER PLAN	ARTIUM-ANDERSEN OR EQUIV. (RO. 3'-1"x6'-11") VERIFY M.O. IN FIELD
14	4'-1"x6'-11"	R-7	NONE	-	PER PLAN	ARTIUM-ANDERSEN OR EQUIV. (RO. 4'-1"x6'-11") VERIFY M.O. IN FIELD
15	3'-0"x6'-8"	NONE	1 HR	HW-1	PER PLAN	* DOOR/FRAME ASSEMBLY, SELF CLOSING
16	4'-1"x6'-11"	R-7	NONE	-	PER PLAN	ARTIUM-ANDERSEN OR EQUIV. (RO. 4'-1"x6'-11")
17	3'-1"x6'-11"	R-7	NONE	-	PER PLAN	ARTIUM-ANDERSEN OR EQUIV. (RO. 3'-1"x6'-11")

NOTE: SEE FLOOR PLANS FOR UNIT INTERIOR DOOR SIZES, SWING AND TYPE

HW-1	3 BUTTS*, STORE ROOM/NEVER LOCKSET	* GC OPTION, SELF CLOSING BUTTS OR DOOR CLOSER
HW-2	3 BUTTS*, DOOR ENTRY LEVEL LOCKSET; THRESHOLD WEATHER STRIPPING; DOOR BOTTOM, DOOR VENER	* GC OPTION, SELF CLOSING BUTTS OR DOOR CLOSER
HW-5	3 BUTTS*, DOOR ENTRY LEVEL LOCKSET; THRESHOLD WEATHER STRIPPING; DOOR BOTTOM	* GC OPTION, SELF CLOSING BUTTS OR DOOR CLOSER
MFG	PER RESIDENTIAL ELEVATOR MANUFACTURER - 2 HR FIRE RATING	

DOOR SCHEDULE & HARDWARE SETS

**WINDOW SCHEDULE**

NO.	SIZE (WxH) OR UNIT NO.	TYPE	FIRE RATING	GLAZING	ROUGH OPENING (WxD)	REMARKS
A	AW251	AWNING	NONE	INSUL. GL.	3'-0" / 2'-5" x 0'-11" / 2"	ANDERSEN OR EQUIV.; INFILL MASONRY OPENING
B	TW2510-5	DOUBLE HUNG	NONE	INSUL. GL.	8'-5 3/4" x 4'-6 1/4"	ANDERSEN OR EQUIV.
C	TW5410-5	DOUBLE HUNG	NONE	INSUL. GL.	10'-5 3/4" x 4'-6 1/4"	ANDERSEN OR EQUIV.
D	REPLACEMENT WINDOW-MATCH EXISTING SIZE	DOUBLE HUNG	NONE	INSUL. GL.	VERIFY M.O. / R.O. IN FIELD	ANDERSEN REPLACEMENT WINDOW OR EQUIV.
E	TW24910	DOUBLE HUNG	NONE	INSUL. GL.	2'-6 1/8" x 6'-11 1/4"	ANDERSEN OR EQUIV.
F	AW251	AWNING	NONE	INSUL. GL.	2'-4 7/8" x 2'-4 7/8"	ANDERSEN OR EQUIV.; INFILL MASONRY OPENING
G	TW41010-2	DOUBLE HUNG	NONE	INSUL. GL.	5'-11 1/8" x 6'-11 1/4"	ANDERSEN OR EQUIV. (EGRESS WINDOW)
H	TW5046	DOUBLE HUNG	NONE	INSUL. GL.	3'-2 1/8" x 4'-9 1/4"	ANDERSEN OR EQUIV. (EGRESS WINDOW)
I	TW5046-2	DOUBLE HUNG	NONE	INSUL. GL.	6'-4 1/4" x 9'-1 1/4"	ANDERSEN OR EQUIV. (EGRESS WINDOW)
J	REPLACEMENT WINDOW-(3) 52"x56"	AWNING	NONE	TEMP. INSUL. GL.	VERIFY M.O. IN FIELD	ANDERSEN REPLACEMENT WINDOW OR EQUIV.; INFILL MASONRY OPENING; INSTALL HEADER
K	AW-2	AWNING	NONE	INSUL. GL.	6'-0 1/2" x 2'-0 5/8"	ANDERSEN OR EQUIV.
L	TW5046-DHP31046-TW3046	DOUBLE HUNG/PICTURE	NONE	INSUL. GL.	TO BE DETERMINED	ANDERSEN OR EQUIV. (EGRESS WINDOW)
M	CMF59-PS059-CMF59	CASEMENT/PICTURE	NONE	INSUL. GL.	VERIFY R.O. IN FIELD	ANDERSEN OR EQUIV.
N	DHP31042	PICTURE	NONE	INSUL. GL.	3'-11 7/8" x 4'-9 1/4"	ANDERSEN OR EQUIV.
O	TW2442	DOUBLE HUNG	NONE	INSUL. GL.	2'-6 1/4" x 4'-9 1/4"	ANDERSEN OR EQUIV.
P	AW251	AWNING	NONE	INSUL. GL.	2'-4 7/8" x 2'-4 7/8"	ANDERSEN OR EQUIV.
Q	REPLACEMENT WINDOW-MATCH EXISTING SIZE	DOUBLE HUNG	NONE	TEMP. INSUL. GL.	T.B.D. IN FIELD	ANDERSEN REPLACEMENT WINDOW OR EQUIV. (EGRESS WINDOW)
R	CR20	CIRCULAR	NONE	INSUL. GL.	2'-0 5/8" x 2'-0 5/8"	ANDERSEN OR EQUIV.
S	REPLACEMENT WINDOW	PIED	NONE	TEMP. INSUL. GL.	VERIFY M.O. IN FIELD	EXISTING WINDOW TO REMAIN APP SINGLE GLAZING SYSTEM SASH (TEMPERED)
T	REPLACEMENT WINDOW-BASMENT	AWNING	NONE	INSUL. GL.	VERIFY M.O. IN FIELD	ANDERSEN REPLACEMENT WINDOW OR EQUIV. (EGRESS WINDOW)
U	REPLACEMENT WINDOW-MATCH EXISTING SIZE	PICTURE	NONE	TEMP. INSUL. GL.	VERIFY M.O. IN FIELD	ANDERSEN REPLACEMENT WINDOW OR EQUIV. (TEMPERED)

WINDOW SCHEDULE